

GENNIE LO-STIK SHIFTER

The *Gennie Lo-Stik* shifter gives you have the ability to interchange different shifter handles and knobs with ease. The Lo-Stik is a modular system where you choose the correct bracket for your transmission, the Lo-Stik shifter unit, a shift handle and knob. Emergency brake handles are also available that bolt to the transmission bracket. This also allows you to keep the shifter assembly and just change brackets if you change transmission types.

Gennie Shifters use a very positive *Gated Lock Out System* and with the solid steel stick and fewer moving parts, your shifter won't have that annoying rattle!

- Lo-Stik features:**
- Neutral safety switch
 - Delrin bushings
 - Hardened Posiloc™ shift gate
 - 303 Stainless parts
 - Precision machine fit
 - Bracket kits include levers, linkage and hardware
 - boots, bezels and back-up light switch available separately.

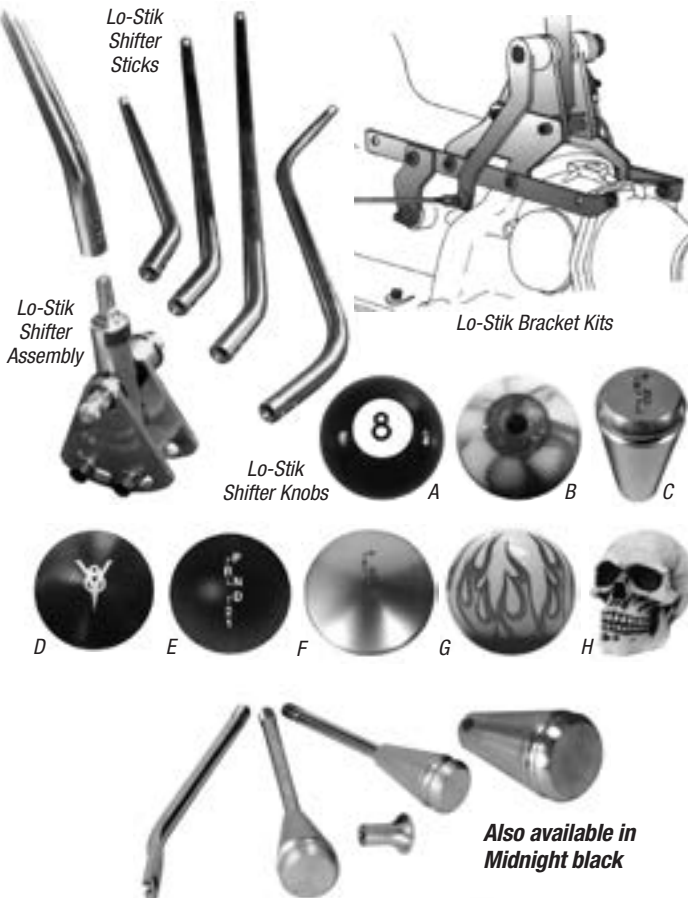

LO-STIK SHIFTER ASSEMBLY

- 1021 GM transmissions \$159.95
- 1022 Ford and MOPAR transmissions..... \$159.95

LO-STIK TRANSMISSION BRACKETS/LINKAGE, Mid-Mount

- Specify GM transmissions, PG, 350, 400, 700, 4L60, 4L60E, 4L80, 200R4 \$74.95
- Specify Ford C4, C6, FMX, AOD, \$74.95
- Specify Chrysler Torqueflite, \$74.95

LO-STIK TRANSMISSION BRACKETS/LINKAGE, Rear-Mount

- All Ford, Chrysler, GM transmissions..... \$74.95

GENNIE SHIFTER STICKS, polished Stainless

- 8" straight, 10", 12", 16" 23" angle. \$78.95
- 28" angle \$95.95
- Swan curved \$100.95

GENNIE SHIFTER CUSTOM KNOBS with 5/16-18 insert

- EP1300 (A) Black 8-Ball, thermoset resin, 2.5" dia. . . \$19.95
- EP1801 (B) Eye Ball, thermoset resin, 2.5" dia \$19.95
- 20008 (C) Aluminum, w/shift pattern (specify) \$14.95
- AL1001 (D) Black V8, aluminum oval \$49.95
- KNOB20011 (E) Black, plastic oval w/shift pattern (specify) \$11.95
- AL1003GS4 (F) Aluminum, oval w/shift pattern (specify).. \$49.95
- EP1405 (G) Flamed Ball, various colors, 2.25" dia ... \$54.95
- SK1001 (H) Skull, hand painted molded resin, 2.75" .. \$19.95

BOOT RING ONLY for using your own boot

- Stainless steel ring only \$26.95

SHIFTER BOOT KITS

Hand stitched vinyl available in black, red, white, tan, maroon or gray. Includes polished stainless steel ring and screws. Black and tan leather also available

- 1005 Shifter Boot kit, mid-mount.....\$54.95
- 1006 Shifter Boot kit, rear-mount.....\$44.95
- 2004 Hand Brake Boot kit,\$44.95
- 2005 Hand Brake Boot kit, Lo-Line\$44.95



COLUMN DRESS-UP KIT

Stainless shafts with billet aluminum knobs. Tilt, bolt-on or screw-in turn signal lever and hazard knob. Shift lever knob sold separately

- 8050 Column Dress-up kit \$49.95
- 8053 Column Shift Knob \$24.95

STEERING HOOK-UP KITS

Complete Kit, Nothing else to buy. Includes u-joints, column adapter, shafting and hardware. Please specify steering column

- SC250 Mustang Rack -Manual \$185.00
- SC260 Mustang Rack -Power..... \$185.00
- SC270 Mustang Rack -Manual w/vibration damp.. \$259.00
- SC280 Mustang Rack -Power w/vibration damp... \$259.00
- SC300 Vega Steering Box Kit \$125.00

KUGEL KOMPONENTS VARI-ANGLE SHIFT ARM KITS

With its unique splined insert the arm can be used at any angle, with any column or floor shifter. Stainless arm is also slotted so shifter or column travel between gears can be matched with the amount of travel needed in the transmission selector. The arm can be purchased alone or with rods for linking column shifters. Fits GM 350, 400 and 700R transmissions. Kit includes arm, two female heim joints, threaded rod, column bushing and hardware.

- 2040 10-1/2" to 17" w/ short rod \$49.95
- 2041 17" to 23-1/2" w/ long rod..... \$49.95



Call 402.886.2275 or click: www.heinzmanstreetrods.com

Gennie Shifters & Lokar Shifters and Hand Brakes

GENNIE SHIFTER HAND BRAKE

These hand brake assemblies are designed to bolt to any Gennie Shifter transmission bracket in the upright position. The handle is 1020 DOM stainless steel tubing with hardened parts. Boot, bracket and cables sold separately.

- 2001 11" handle assembly \$169.95
- 2002 16" handle assembly \$169.95

Lokar Handbrake Handle Bracket



Lokar Floor Mount Handbrake Handle



Lokar Transmission Mount Handbrake Handle

GENNIE SHIFTER LO-LINE FLOOR MOUNT

This hand brake is designed to mount flat to the floor. The handle is 304 stainless steel construction with hardened parts micro switch for indicator light. Boot and cables sold separately.

- 2003 16" handle assembly \$129.95



GENNIE SHIFTER BRAKE CABLE KITS

Includes 9 feet of heavy-duty cable and hardware to connect Gennie Shifter handbrake handle to most applications. You cut to fit.

- 2006 GS2* two cables for most drum brakes. \$129.95
 - 2007 GS1* one cable for Jag rear ends \$71.95
 - 2008 UN2* two cables for most drum brakes \$129.95
 - 2009 UN1* one cable for Jag rear ends \$71.95
 - 2010 FF1* one cable for original style Ford underdash handles to UN2 \$71.95
- Clevis Clamp kits to adapt cables to different rear ends, 1/4" pin, 5/16" pin, Corvette, Explorer . . . \$10.95

*UN is for universal, GS is for Gennie Shifter handles

TRI-5 CHEVY REPLACEMENT CABLE

This is a direct replacement cable that uses high quality Gennie Shifter stainless steel inner cable. 123" long with correct ends.

- 2003 1955-57 Chevy \$129.95



LOKAR AUTOMATIC TRANSMISSION SHIFTERS

Lokar Shifters use a safety lock-out button to prevent accidental shifting from park into reverse, drive, and low gears. The safety lock-out button is flush with the knob, and is virtually undetectable. Shifter Knob Adapters are available to personalize their shifter with a custom knob. Lokar's main plate and side brackets allow the shifters to be mounted in a number of positions front to rear.

Features Include • Positive Lock-Out in Park and Neutral with push-button aluminum knob • Neutral Safety Switch • High quality rod ends • Levers available in 32", 23", 16", 12", 10", 8" and 6" lengths • Choice of Teflon-lined shifter knob buttons • Gold irradiated main plate and brackets • All hardware included • Shifter Boots sold separately • Vertical style parking brake handle can be bolted to shifter bracket

For Ford, GM and Chrysler. \$329.95

Lokar Shifters are also available in Midnight black

Choice Of Push Button Knobs

Lokar Shifter Kit

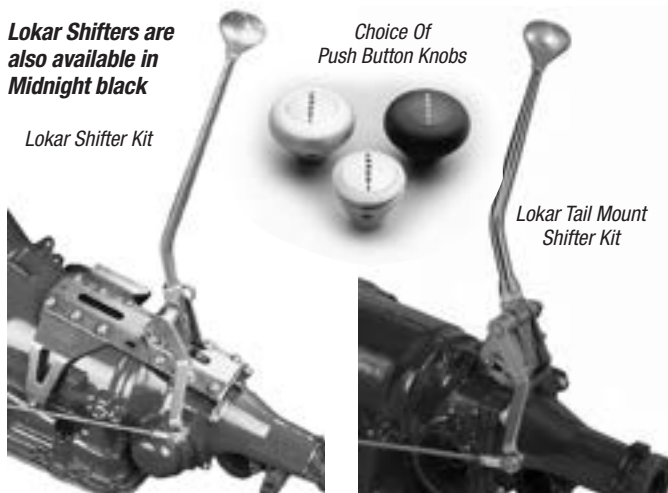

Lokar Tail Mount Shifter Kit

Lokar Floor Mount Shifter Kit

Lokar Nostalgia Shifter Kit

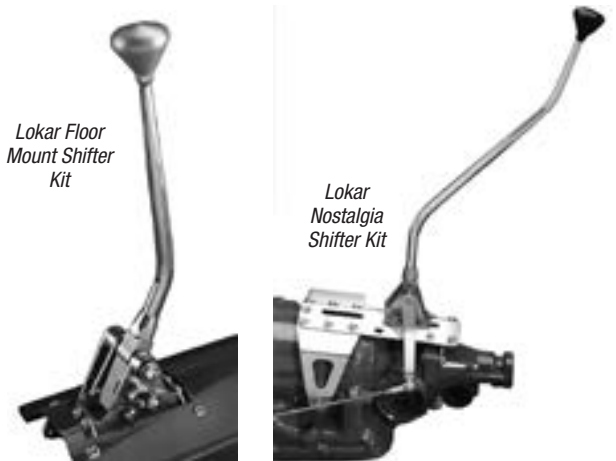

LOKAR TAIL MOUNT SHIFTER

This shifter has most of the same features as the regular shifter except it bolts to the tail shaft bolts. Choice of two positions.

Tail shaft mount for Ford, GM and Chrysler \$279.95

LOKAR FLOOR MOUNT SHIFTER

Bolts to the floor instead of transmission. Includes three different offset levers for clearance. Also available with cable actuation.

Floor mount for Ford, GM and Chry, non-cable style. . . \$329.95

Floor mount for Ford, GM and Chry w/cable, 16" lever. \$339.95

LOKAR NOSTALGIA SHIFTERS

Uses a single or double bend shifter handle 16, 23 or 32" long.

Nostalgia Shifter for Ford, GM and Chrysler, 16-23" . . . \$349.95

Nostalgia Shifter for Ford, GM and Chrysler, 32" \$399.95

Lokar Floor Mount
E-Brake Handle

Lokar hand brakes
are also available
in Midnight black

Lokar Trans
Mount E-Brake
Handle

LOKAR HAND BRAKES

TRANS MOUNT

These hand brake assemblies are designed to compliment the Lokar shifter styling and bolt to the Lokar transmission bracket in the upright position. The chrome handle is available 10 or 16" long. Ratchet gear and lock are hardened for long life and safety. Boot and cables are sold separately.

- EHB-7011 11" handle transmission mount\$159.99
- EHB-7016 16" handle transmission mount\$159.99

FLOOR MOUNT HAND BRAKE

This hand brake has the same features, but is designed to mount flat to the floor. May also be mounted sideways in front of the drivers seat. Unit measures 10" end to end. Boot and cables are sold separately.

- EHB-7000F Floor mount lever.....\$119.95
- EHB-7001 Warning light switch kit\$33.95

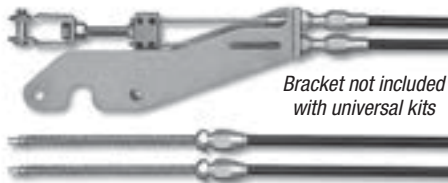

Bracket not included
with universal kits

LOKAR BRAKE CABLE KITS

These cable sets are designed to work with the Lokar trans mount hand brake bracket or use the universal kits for the floor mount unit. The universal set does not include the bracket that bolts to the vertical hand brake bracket. Sets include two 8 foot stainless steel cables, ends and hardware. Available with black or braided stainless housing. You cut to fit. Kits are available for Ford, Chevy Chrysler drums, Ford and Lincoln discs, Corvette, Jag, Wilwood, SSBC and Baer discs and universal. Please specify

- EC-80TU Trans mount cables, black housing\$143.95
- EC-80THT Trans mount cables, stainless housing ...\$179.95
- EC-80FU Universal cables, black housing.....\$134.95
- EC-80FHT Universal cables, stainless housing.....\$179.95

UNDER-DASH CONNECTOR CABLES

These cables connect a Lokar under-dash hand or foot operated parking brake to the universal brake cable kit. Single cut to fit cable is 6 foot and available in black or stainless. Also for some factory hand brake handles.

- EC-8001U Universal Connector cable, black.....\$95.95
- EC-8001HT Universal Connector cable, stainless.....\$139.95
- EC-8000U Cable for 1937-48 Fords, black.....\$95.99
- EC-8000U* Cable for 1937-56 Ford Trucks, black\$95.99
- EC-8002U* Cable for 1937-48 Dodge/Plym, black\$95.99
- EC-8003U* Cable for 1939-48 Chevy, black\$95.99

*specify black or stainless steel outer housing



LOKAR UNDER-DASH HAND BRAKES

These hand brake assemblies mount under the dash for a clean, out of the way emergency brake. The pedal arm is available solid or with widows and with a ball milled or rubber insert pedal pad. Unit is about 12" high and adjusts from 9 to 13" deep with universal brackets. Use with the connector cables, below left.

- EFB-9000 Billet aluminum w/ball milled pad\$227.95
- EFB-9001 Billet aluminum w/rubber insert pad\$227.95
- EFB-9000 Billet alum. w/windowed arm, ball milled pad . \$227.95
- EFB-9001 Billet alum. w/windowed arm, rubber insert pad . \$227.95

Also available chrome and midnight black



LOKAR BRAKE CABLE CLEVIS KITS

Adapts Lokar cables to disc brake emergency brake linkage

- EC-80WC Wilwood and 1988-up Corvette\$26.95
- EC-80CC 1984-87 Corvette\$34.95
- EC-81FC Ford Explorer\$34.95

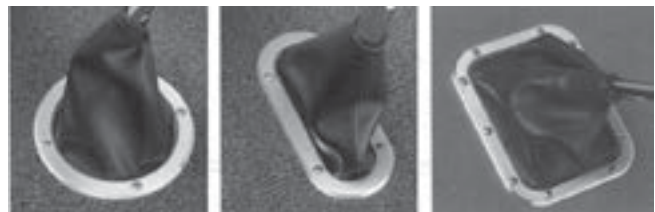

LOKAR BOOT KITS

Lokar boots are black Naugahyde with a polished stainless steel bezel and stainless screws.

- 70-BHRB Shifter boot kit, with round bezel\$33.95
- 70-EHBT Hand brake boot kit\$27.95
- 70-BHBF Floor hand brake boot kit\$27.95

Also available in midnight black. Also available with LED indicators.

B&M QUICKSILVER SHIFTER

The B&M QuickSilver can be ratcheted up or down between neutral and low with the stick remaining in the centered position. When in the drive position, the stick can be pulled up, releasing ratchet mode and allowing lever movement directly to reverse or park. Cable and hardware included. Works with GM TH400, 350, 250, and 200, Ford C4, C6, and AOD, 1966-Up Chrysler Torqueflite A-727 and A-904

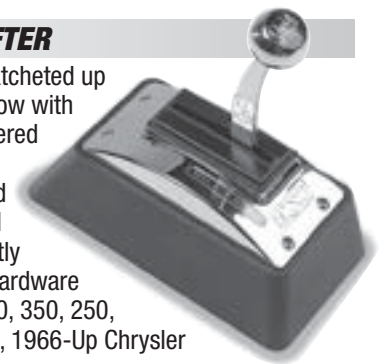

- 80683 Universal.....\$299.95



LOKAR SHIFT KNOBS

Aluminum knobs with teflon lined push-button lockout. Specify with or without shift pattern on button. These work on Lokar shifters only.

- SK-6850 8-ball\$61.99
- SK-6851 Piston\$46.99
- SK-6861 Polished skull with plain button\$73.99
- SK-6862 Polished skull with 3 speed auto button ...\$73.99
- SK-6878 Shift knob adapter for regular 3/8-16 knob...\$29.95
- SK-6879 Shift knob adapter for regular 3/8-24 knob ...\$29.95

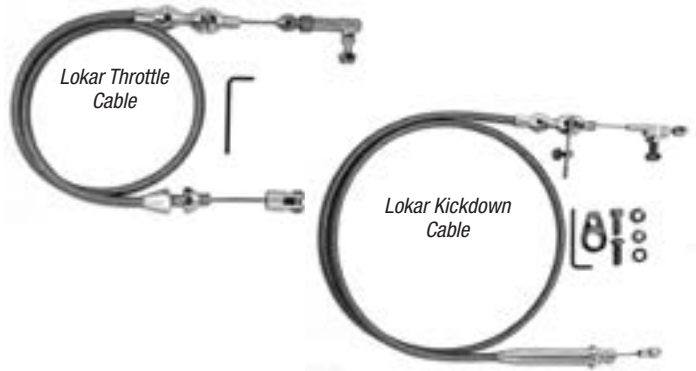

LOKAR THROTTLE & KICKDOWN CABLES

Available with braided stainless or black housing with a specially extruded inner liner and stainless wire. Throttle cable clevis adopts to most factory and aftermarket pedals.

- TC-1000HT 24" stainless steel throttle cable\$54.95
- TC-1000HT36 36" stainless steel throttle cable\$59.95
- TC-1000TP Chevy TPI stainless steel throttle cable ...\$55.95
- TC-1000LS1 Chevy LS1 Ramjet SS throttle cable\$62.95
- TC-1000TPV Chevy Vortec SS throttle cable\$59.95
- KD-2350HT GM TH-350 Kickdown SS cable.....\$81.99
- KD-22400HT GM TH-400 Kickdown SS cable.....\$81.99
- KD-20PGHT GM Powerglide Kickdown SS cable\$81.99
- KD-2700HT GM 700R4 Kickdown SS cable\$81.99
- KD-2200RHT GM 200-4R Kickdown SS cable.....\$81.99
- KD-20C4HT Ford C4 Kickdown SS cable\$81.99
- KD-20C6HT Ford C6 Kickdown SS cable\$81.99
- KD-2A0DHT Ford AOD Kickdown SS cable\$81.99
- KD-2727HT Chrysler 727 Kickdown SS cable\$81.99
- KD-2904HT Chrysler 904 Kickdown SS cable\$81.99

Lokar Shifters and Hand Brakes



LOKAR THROTTLE PEDALS

Lokar throttle pedals are available in chromed steel or billet aluminum. Throttle pad is spring loaded and lower arm is splined and can mount on right or left side of bracket. Brake pads have a 1/2 x 20 stud.

- SPO-6070 Chromed steel spoon throttle\$61.55
- SPO-6071 Chromed steel round brake pedal\$43.95
- SPO-6071 Chromed steel round dimmer\$23.95
- SG-6007 Chromed steel throttle pedal\$108.95
- SG-6008 Chromed steel rectangular brake pedal\$45.95
- SG-6009 Chromed steel rectangular dimmer\$21.95
- BAG-6001 Billet throttle pedal\$135.95
- BAG-6002 Billet rectangular brake pedal\$45.95
- BAG-6003 Billet rectangular dimmer\$21.99
- BAG-6004 Billet throttle pedal w/rubber insert.....\$135.95
- BAG-6005 Billet rectangular brake pedal w/rubber ...\$45.95
- BAG-6006 Billet rectangular dimmer w/rubber\$21.95



PHOENIX TV CABLE CARBURETOR LEVER

We use these handy Phoenix Transmission Products TV cable correction brackets for the Holley, Demon and Edelbrock carburetors. These simply bolt to your existing carb linkage with included hardware and provide perfect TV geometry for proper operating pressure and shift timing for TV cable equipped 700R4, 2004R, and Ford AOD. Use with Lokar or OEM TV cables.

- PTVLVRHLY Holley carbs\$31.00
- PTVLVRAFB Edelbrock and Carter\$31.00
- PTVLVRBG Barry Grant\$31.00

LOKAR THROTTLE CABLE BRACKET AND SPRING

Polished stainless bracket mounts to the back bolt on Holley, Edelbrock, Carter, demon and in-line dual quads. Locates the throttle and kickdown cable and spring.



- SRK-4000 Carburetor bracket and spring\$29.95
- TRP-4003 Rochester tri-power bracket and spring ...\$46.95
- TCB-40LT1 Chevy LT-1 bracket\$61.95
- TCB-40LT4 Chevy LT-4 bracket\$61.95
- TCB-40EFI 1986-93 Ford EFI bracket\$61.95
- TCB-40RJ Chevy Ramjet EFI bracket\$61.95

NO-SLIDE TV AND THROTTLE CABLE BRACKET

TV (throttle valve) cables offer a lot more tension than old style kick-down cables and can sometime pull carb brackets out of adjustment. This bracket bolts between the carb and manifold and can't move.

- Four barrel Holley and Edelbrock carbs\$49.95



LOKAR DIP STICKS

Lokar teflon lined braided stainless engine and transmission dipsticks use an easy to read teflon inner rod that's calibrated for each application. Transmission dipstick is available with a bell housing bracket or firewall mounting. All firewall mount are 24" long. Dipstick seals with o-rings. Transmission kits include a funnel adapter for easy filling. Engine dipsticks have brackets for factory or Sanderson headers

Firewall mount for most transmissions	\$89.95
Bell housing mount for most transmissions	\$89.95
ED-5001 Engine, Small Block Chevy, 1980 up	\$61.95
ED-5003 Engine, Big Block Chevy	\$61.95
ED-5006 Engine, 502 Big Block Chevy	\$61.95
ED-5004 Engine, 302 Ford, 1986-95	\$61.95
ED-5010 Engine, 289-302 Ford, 1962-69	\$61.95
ED-5008 Engine, GM LS1, 1997 up	\$61.95

LOKAR HOOD & TRUNK CABLE RELEASE KITS

Billet aluminum handle with braided stainless or black housing with a specially extruded inner liner and stainless wire. Hood release cable is 6 feet and trunk is 15 feet and are cut-to-fit. A combination unit is also available. Cable operated mechanisms are required.



CHT-1300HT	Combination release, stainless cable	\$210.95
CHT-1300U	Combination release, black cable	\$171.95
TR-1200HT	Trunk release, stainless cable	\$124.95
TR-1200U	Trunk release, black cable	\$99.99
HR-1100HT	Hood release, stainless cable	\$109.95
HR-1100U	Hood release, black cable	\$89.99



LOKAR HEADLIGHT CONDUIT

Lokar teflon lined braided stainless headlight wire covers are designed with a threaded steel stud and aluminum ends. Includes headlight wires.

HL-1900	Stainless Headlight Braid, 12" long	\$82.99
----------------	--	-------	----------------



LOKAR COLUMN DRESS-UP KIT

Machined from billet aluminum in one piece with a satin finish. Fits all GM columns and includes the turn signal and tilt lever and flasher button.

DUK-2200	Column dress-up kit	\$42.99
-----------------	----------------------------	-------	----------------



LINE CLAMPS

Kugel Komponenten' stainless steel hold down clamps are available in a variety of configurations and sizes. They're used to secure items like hard lines, hoses, cables, and wire looms to the frame or body. Packaged with stainless steel 10/32 button head allen screws and stainless steel sheet metal screws. Many more combinations than we can list here, so give us a call. Only one size per pack.

Single clamps, 3/16, 1/4, 5/16, 3/8, 1/2, 12/pack	\$16.95
Single clamps, 5/8, 3/4, 7/8, 8/pack	\$16.95
Double clamps, 3/16, 1/4, 5/16, 3/8, 1/2, 6/pack	\$16.95
Double clamps, 5/8, 3/4, 7/8, 4/pack	\$16.95
Combination clamps, 3/16 x 3/8 or 5/16 x 3/8 6/pack	\$16.95



Lokar Shifters and Hand Brakes